

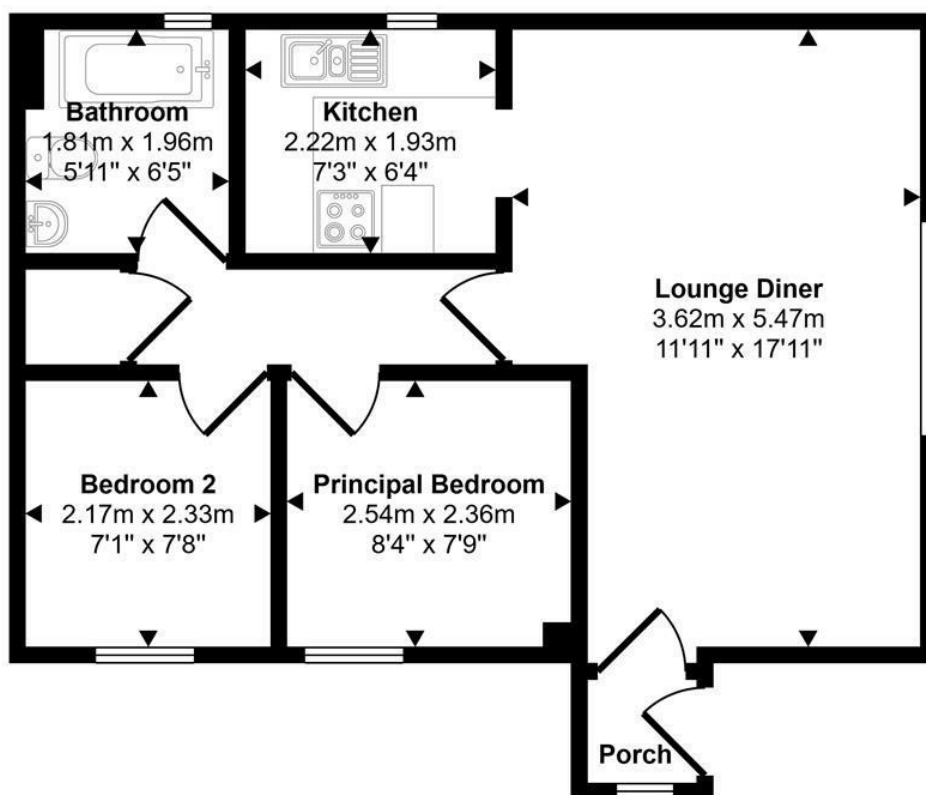

Manor Court | Norwich | NR11  
 £150,000

Approx Gross Internal Area  
 45 sq m / 482 sq ft



Floorplan

This floorplan is only for illustrative purposes and is not to scale. Measurements of rooms, doors, windows, and any items are approximate and no responsibility is taken for any error, omission or mis-statement. Icons of items such as bathroom suites are representations only and may not look like the real items. Made with Made Snappy 360.

Energy Efficiency Rating		
	Current	Potential
Very energy efficient - lower running costs		
(92 plus) <b>A</b>		
(81-91) <b>B</b>		
(69-80) <b>C</b>	73	75
(55-68) <b>D</b>		
(39-54) <b>E</b>		
(21-38) <b>F</b>		
(1-20) <b>G</b>		
Not energy efficient - higher running costs		
<b>England &amp; Wales</b>	EU Directive 2002/91/EC	

Disclaimer – In accordance with the Property Misdescriptions Act, the company gives notice that all descriptions, references to condition, necessary permissions for use and other details are given in good faith and believed to be correct, but any intending lessees do not rely on them as statements of fact, but must satisfy themselves by inspection or other means, as to their accuracy.

abbotFox presents this chain free, ground floor apartment. Set within the popular and well-serviced town of Aylsham, this home is ideally located within easy reach of the town centre and a wealth of local amenities.

The accommodation on offer is neatly arranged and comprises; a private porch entrance, generous lounge diner, kitchen, two bedrooms and a family bathroom. The property further benefits from an allocated parking space. An ideal opportunity for any first time buyer, an internal viewing comes highly recommended.

